



Pumps



**CARE - WELL ENGINEERS**

**Industrial Pumps & Spares**





## Company

**CARE-WELL ENGINEERS** an Ahmedabad based Company Established in 2003, We are Dealing in Centrifugal Process Pumps, Gear Pumps, Boiler Pumps & Spares. The company was started by Mr. Niket Dave who started his Journey since Last 2 Decades in Industry. With his Vast Experience and Focus on Quality, the company today known world over for Quality pumps & Quick Service. **CARE-WELL ENGINEERS** has Aspire to break New Grounds in the Pumping Industry through persistent Innovation & Improvement.

**CARE-WELL ENGINEERS** also specialize in providing Spares of Centrifugal Process Pumps in various materials of construction like CI, SS304, SS316, SS316L, Alloy20 and Hast Alloy etc. which can replace OEM parts of any make of pumps and that too in shortest possible time to avoid 'Downtime' losses there by proving to be a dependable solution provider.

**CARE-WELL ENGINEERS** a leading name in Fluid Handling also supplies World class 'Mechanical Shaft Seals' for prevention of leakages during pumping process. These Mechanical Seals are available in different materials of construction and in configuration as single, double or Reverse Balance Seals, Cartridge Type and Metal Bellow Seals.

To work Relentlessly to Achieve our Vision Statement. **Care-Well** Shall Provide & Spread Technological Innovations to their Customers from time to time. Quality, Quick Deliveries and Excellent after-sales-service to make its presence felt by all associated for Mutual Benefits and Profits.

## Mission

## Vision

To Be the Most Trusted & Accepted Global Brand in The Fluid Handling Products. To Be the One of the Best Companies in Segment & Continuously Aspires for Quality & Client Satisfaction by Providing the Great Solution.



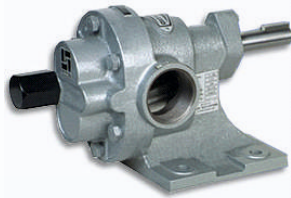

"CI ROTARY GEAR PUMP"

**SERIES-CW**



"SS ROTARY GEAR PUMP"

**SERIES- CWSS**



"FUEL INJECTION GEAR PUMP"

**SERIES- FIG**

**Application**

REFINERIES, MINERAL OILS, PRINTING INKS, DYES & RESINS, ALL TYPE OF FUELS, POWER PLANTS, STEEL PLANT, GLYCERIN - GLYCOL & SOAP SOLUTION, OIL STORAGE INSTALLATION, SUGAR MOLASSES & SYRUPS

PHARMACEUTICAL INDUSTRIES, COSMETIC INDUSTRIES, DYES & RESINS, DYEING AND PRINTING HOUSE, GHEE, BUTTER, FRUIT PULPS, VEGETABLE SOUPS.

OIL BURNER, HYDRAULIC DRIVE & PRESSURE-PUMP, PRESSURE AND TRANSFER PUMP, FOR GAS OIL, MEDIUM, HEAVY AND VERY HEAVY OIL, PUMP FOR LUBRICATION OIL & HYDRAULIC OIL, PUMP SUITABLE FOR LDO, FO, HSD & LSHS, PUMP FOR FORCE FEED LUBRICATION.

**Features**

SIMPLE AND EFFICIENT DESIGN, SINGLE HELICAL GEAR DESIGN, LOW NOISE, EASY TO MAINTAIN. OPTIONALLY AVAILABLE IN DOUBLE HELICAL GEAR DESIGN. BI-DIRECTION POSITIVE DISPLACEMENT PUMP.

SELF PRIMING PUMP, SINGLE HELICAL DESIGN, EASILY CLEANABLE & LOW MAINTENANCE. ANTI-CORROSIVE. OPTIONALLY AVAILABLE IN DOUBLE HELICAL GEAR DESIGN.

MAXIMUM TEMPERATURE UP TO 200° C, CONTINUES DUTY PUMP, INTERNAL LUBRICATION SYSTEMS. HIGHER SUCTION LIFT.PRESSURE REGULATOR, PROGRESSIVELY ADJUSTABLE.

**Range**

CAPACITY : UP TO 30 M3/HR  
 SIZE : 1/4" X 1/4" TO 3" X 3"  
 (6.35 MM TO 75 MM)  
 SPEED : UP TO 1400 RPM  
 PRESSURE : UP TO 10 kg/cm<sup>2</sup>  
 M.O.C : IS.210 FG 220 C.I. Grade

CAPACITY : UP TO 18 M3/HR  
 SIZE : 1/4" X 1/4" TO 2 1/2" X 2 1/2"  
 (6.35 MM TO 62.5 MM)  
 SPEED : UP TO 1400 RPM  
 PRESSURE : UP TO 10 kg/cm<sup>2</sup>  
 M.O.C : CF-8M (SS-316)

CAPACITY : UP TO 6 M3/HR  
 SIZE : 3/8" x 3/8" to 1" x 1"  
 (9.5 MM to 25 MM)  
 SPEED : 1400 RPM/2800 RPM  
 PRESSURE : UP TO 30 kg/cm<sup>2</sup>  
 M.O.C : IIS.210 FG 220 C.I. Grade





"POSITIVE DISPLACEMENT GEAR PUMP"

**SERIES- CWRN**



"LOBE ROTARY PUMP"

**SERIES-CWLB**



"CHEMICAL PROCESS PUMP"

**SERIES-CWPCF**

**Application**

POWER PLANT, STEEL PLANT, BITUMEN PLANT, REFINERIES, PUMPING STATION, ALL KIND OF LIQUID LOADING & UNLOADING ALL TYPES OF OILS, BITUMEN PLANT.

BATTERS, FLAVOURINGS, FROSTINGS, FRUIT FILLINGS, FAT & OILS, SWEETENERS, YEAST SLURRY, TOMATO & FRUIT PASTE , CREAM STYLE , VEGETABLES, PUDDINGS, JAMS, JELLIES, MAYONNAISE, SOUPS, STEWS. CREAM, MILK, CHEESE, CURD & WHEY, COTTAGE, CHEESE, YOGURT, MARGARINE, BUTTER, BEER, WORT YEAST, ALCOHOLS & WINES SOFT DRINKS.

TEXTILE-JET DYEING, COLD-HOT WATER SYSTEM, MARINE APPLICATION, FIRE FIGHTING APPLICATION, POWER STATION & PROCESS INDUSTRIES, HANDLING OF ALL TYPES OF LIQUIDS.

**Features**

DOUBLE HELICAL GEAR DESIGN PREVENT AXIAL LOAD, SHORTER BEARING SPAN REDUCES BENDING EFFECT, OPTIONALLY STEAM JACKET AVAILABLE, HEAVY DUTY GEAR PUMP DESIGN FOR CONTINUOUS APPLICATION.

SELF PRIMING POSITIVE DISPLACEMENT ROTARY LOBE PUMPS. EASY-CLEAN PUMP OF HEAD WHICH IS IDEAL FOR IN PLACE CLEANING, OR CAN BE RAPIDLY STRIPPED FOR MANUAL CLEANING, WITHOUT DISCONNECTING THE PIPE WORK. PUMPING CHAMBERS ARE WITHOUT POCKETS OR CREVICES TO HARBOR BACTERIA OR CONTAMINANTS.

CAPABLE TO PERFORM FOR LONG RUNS WITHOUT FAILING. EXCELLENT RESISTANCE TO ALL TYPES OF CORROSIVE CHEMICALS, BACK PULLOUT OPHOV IS ALSO AVAILABLE.

**Range**

CAPACITY : UP TO 125 M3/HR  
 SIZE : 1/2" X 1/2" TO 6" X 6"  
 (12MM TO 150MM)  
 SPEED : UP TO 1400 RPM  
 PRESSURE : UP TO 10 kg/cm2  
 M.O.C : CI/CS

CAPACITY : UP TO 15 M3/HR.  
 SIZE : 1/2" X 1/2" TO 3" X 3".  
 (12 MM TO 75 MM)  
 SPEED : UP TO 1000 RPM.  
 PRESSURE : UP TO 7 KG/CM2.  
 M.O.C : CF-8M (SS-316)

CAPACITY : UP TO 250 M3/HR  
 SIZE : 1" TO 8"  
 (25 MM TO 200 MM)  
 SPEED : UP TO 2800 RPM  
 PRESSURE : UP TO 35 kg/cm2  
 M.O.C : CI/CS/SS-316/ALLOY-200



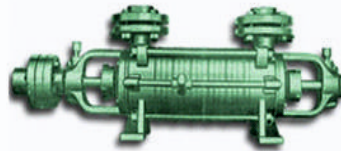

"MULTISTAGE BOILER FEED PUMP"

"SELF PRIMING MULTISTAGE PUMP"

"MUD SELF PRIMING CENTRIFUGAL PUMP"

**SERIES-CWB**

**SERIES : CWRO**

**SERIES : CWMP**

**Application**

BOILER FEED WATER IRRIGATION ,  
INSTALLATIONS FIRE FIGHTING ,  
PRESSURE BOOSTING, CIRCULATION  
OF HOT & COLD WATER

BOILER FEED WATER IRRIGATION  
INSTALLATIONS, FIRE FIGHTING,  
PRESSURE BOOSTING, FUEL PUMPING  
HANDLING, HYDRAULIC PRESS.

DEWATERING BASEMENTS, TRENCHES,  
CONSTRUCTION SITES, ANY  
APPLICATION WHERE PRIMING IS TO  
BE AVOIDED, PUMPING MUDDY  
WATER, SEWAGE, POLLUTED LIQUIDS,  
SWIMMING POOLS

**Features**

ENERGY EFFICIENT HYDRAULIC WATER  
LOW NOISE EASY INSTALLATION &  
MAINTENANCE, ESPECIALLY AVAILABLE  
WITH MECHANICAL SEAL

SUCTION & DISCHARGE NOZZLES  
ARE TOP VERTICAL VERTICALLY  
SPLIT SUCTION, MAINTENANCE, E  
SPECIALLY AVAILABLE WITH  
MECHANICAL SEAL

EXCELLENT, QUICK, AUTOMATIC WITHOUT  
FOOT VALVE UP TO 8 METERS. AUTOMATIC  
AIR RELEASE DURING PRIMING. BACK-PULL  
PUT DESIGN, AVAILABLE WITH GLAND  
PACKING & MECHANICAL SEAL.

**Range**

CAPACITY : UP TO 30 M3/HR  
SIZE : 1.5" X 1.5" TO 3" X 3"  
(40 MM X 75 MM)  
SPEED : UP TO 2800 RPM  
PRESSURE : UP TO 35 kg/cm2  
M.O.C : CI/BRONZE

CAPACITY : UP TO 20 M3/HR  
SIZE : 1" X 1" TO 2" X 2"  
(25MM TO 50MM)  
SPEED : UP TO 1400 RPM  
PRESSURE : UP TO 15 kg/cm2  
M.O.C : CI/SS/BRONZE

CAPACITY : UP TO 250 M3/HR  
SIZE : 1.5" X 1.5" TO 6" X 6"  
(40MM TO 150MM)  
SPEED : UP TO 2800 RPM  
PRESSURE : UP TO 35 kg/cm2  
M.O.C : CI/SS-316





"AIR COLLED PUMP"

**SERIES : CWAP**



"POLYPROPYLENE PUMP "

**SERIES- CWPPC**

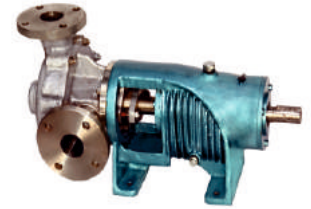

"SIDE SUCTION CENTRIFUGAL PUMP"

**SERIES- CWCFF**

### Application

DISTILLATION PLANTS BAKING OVENS  
BITUMEN TANK FARMS ROOFING FELT  
PRODUCTION SYSTEMS, HEAVY OIL PLANTS  
STARCH-DRYING SYSTEMS, SOAP AND  
DETERGENT INDUSTRY, WOOD AND  
PAPER INDUSTRY

ACID/ALKALI TRANSFER, RECIRCULATION  
OF ELECTROLYTE, FOR DESCALING OF  
TUBES, FILTRATION SCRIBBLING OF  
CORROSIVE GASES LIKE Cl<sub>2</sub>, Br<sub>2</sub>, So<sub>2</sub>.

FILTER PRESS FEEDING, EFFLUENT  
TREATMENT PLANT, DYES &  
INTERMEDIATES, INDUSTRIAL  
APPLICATIONS, SLURRY TRANSFER,  
CHEMICAL PROCESS, SCRUBBER  
APPLICATION

### Features

EASILY DISMANTLED BEARING BRACKET,  
SINGLE MECHANICAL SEAL IN TANDEM  
ARRANGEMENT, OPTIMIZED HYDRAULIC  
SYSTEM FOR HIGH EFFICIENCY,  
IMPELLERS TRIMMED AS STANDARD FOR  
PUMP OPERATION AT BEST EFFICIENCY  
POINT.

DESIGN TO SUIT EXTREMELY  
CORROSIVE DUTIES IN PROCESS  
& CHEMICAL INDUSTRIES LESS  
EXPENSIVE AND MOST IDEAL  
PUMPS THAN OTHER PUMPS  
LIKE AS SS & ALLOY METALS

EASY TO MAINTAIN DURABLE,  
REPLACEABLE PARTS FOR POSITIVE  
SUCTION, HEAVY DUTY

### Range

CAPACITY : UP TO 250 M3/HR  
SIZE : 1.25" X 1.25" TO 3" X 3 "  
( 32 MM TO 80 MM)  
SPEED: UP TO 2800 RPM  
PRESSURE : UP TO 8 kg/cm<sup>2</sup>  
M.O.C : CI/CS/SS-316

CAPACITY : UP TO 60 M3/HR  
SIZE : 1" X 1" TO 3" X 3 "  
(25MM TO 75MM)  
SPEED : UP TO 2800 RPM  
PRESSURE : UP TO 6.5 kg/cm<sup>2</sup>  
M.O.C : PP/PVDF/UHMWPE

CAPACITY : UP TO 35 M3/HR  
SIZE : 1" TO 3 "  
( 25MM TO 75 MM)  
SPEED : UP TO 2800 RPM  
PRESSURE : UP TO 10 kg/cm<sup>2</sup>  
M.O.C : CI/CS/SS-316/SS-304





We also deal in pump spares & mechanical Seals



## OUR VALUABLE CLIENTS



ISHAN



TNV Certification Pvt. Ltd.



PUMPS

## CARE - WELL ENGINEERS

Industrial Pumps & Spares

10, Patel Estate, Opp. Rudraksha way bridge,  
Trikampura Road, GIDC, Vatva, Ahmedabad.

Website : [www.carewellpumps.com](http://www.carewellpumps.com)

E-mail : [carewellpumps@gmail.com](mailto:carewellpumps@gmail.com)

Phone. : (079) 25460988

Mobile : +91 98255 03966, 94092 11227